

Information

This installation guide contains quick information required for the product installation. Refer to the User's Manual in the website that comes with the product for detailed installation instructions. The website contains the following information.

1. Manual: User's, Bluetooth Connection, BXL/POS Command, Code Pages, Software
2. Driver: Windows, OPOS, JPOS, CUPS(Linux, Mac)
3. SDK: UPOS SDK(android, iOS), Windows SDK
4. Utility: Bixolon Utility (Android, iOS), Unified Mobile Utility

We at BIXOLON Co., Ltd. maintain ongoing efforts to enhance and upgrade the functions and quality of all our products. In following, product specifications and/or user manual content may be changed without prior notice.

Please refer to the BIXOLON website for the addresses and phone numbers of the company's headquarters and branch offices. (<http://www.bixolon.com>)

Content Confirmation

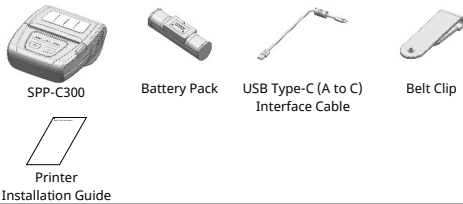

Product Part Names

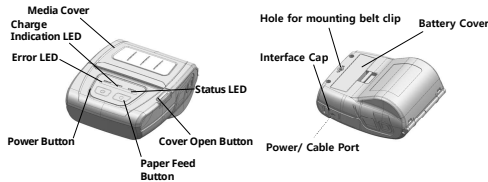

Installation and Charging

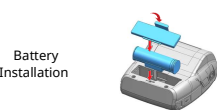

- 1) Insert battery into the printer as pictured.
- 2) Connect the hook of the battery cover to the bottom of the printer.
- 3) Press the battery cover into place until you hear a "click" sound.

Since the battery is partially charged at the time of purchase, charge the battery prior to product use.

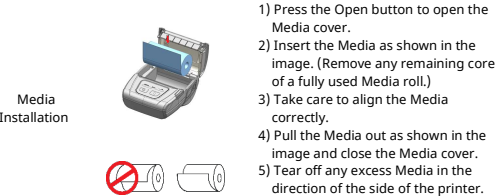

- 1) Press the Open button to open the Media cover.
- 2) Insert the Media as shown in the image. (Remove any remaining core of a fully used Media roll.)
- 3) Take care to align the Media correctly.
- 4) Pull the Media out as shown in the image and close the Media cover.
- 5) Tear off any excess Media in the direction of the side of the printer.

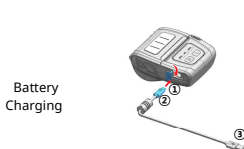

- 1) Turn off the printer power.
- 2) ① Open the external interface cap.
- 3) Connect USB Type-C cable ② to printer power/cable port.
- 4) Charge after connecting USB Type-C cable ③ to your device's (PDA, PC, etc.) USB port.



- Charge the battery only after disconnecting the power to your device.
- Use only genuine products supplied by Bixolon. Otherwise, the product may malfunction or there is a risk of personal injury.

Belt Clip
Installation



- 1) Insert the belt clip screw into the belt clip hole.
- 2) Use a coin to tighten the belt clip screw as shown in the image.

Control Panel Usage

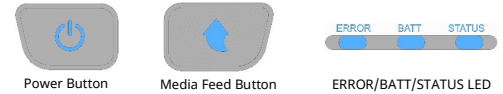

- **Power Button**
This button is used to turn the printer on and off.
- **Media Feed Button**
To feed media manually, press this button.
- **ERROR LED**
If the red LED is blinking, the media cover is open or missing, or the head is overheated. If the red LED continues to blink, it may indicate a more serious problem with the product.
Call your authorized service center.
- **BATT LED**
If the green LED is lit, the battery is fully charged.
If the green LED is blinking, the battery is half charged.
If the red LED is blinking, the battery must be charged or replaced.
- **STATUS LED**
When using Bluetooth, if the green LED and the battery indicator are both on, the printer is connected to Bluetooth.

Self-Test

Run the self-test to check the setting information when you are setting up the printer for the first time or if there is a problem.

If no issue is found with the printer after running the self-test, examine the other devices or peripherals and software. This function is independent of such other devices and software.

Self-Test Instructions

- 1) Turn the printer power off and close the printer media cover.
- 2) Press and hold the media feed button and power button simultaneously to turn on the printer.
- 3) After printing begins, release the two buttons.

Peripherals Connection

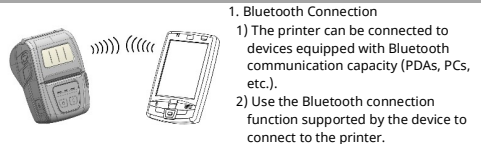

- Refer to the Bluetooth Connection Manual for detailed information on its connection.
- You can check the bluetooth environment (authentication, encryption, connection mode) via the self-test page.



2. Interface Cable Connection
1) ① Open the external interface cap.
- 2) Connect USB Type-C Cable ② to printer power/cable port.
- 3) Connect USB Type-C cable ③ to your device's (PDA, PC, etc.) USB port.



A USB Type-C cable that supports USB 2.0 or a USB Type-C cable supplied (sold separately) by Bixolon can be used as an interface cable.

Product Specifications

	Item	Description
Printing	Printing Method	Direct Thermal printing
	Printing Speed	Up to 50 mm/s (1.97 ips)
	Resolution	203 dpi
	Character Size	Font A: 12 × 24 Font B: 9 × 17 Font C: 9 × 24
	Characters Per Line	Font A: 48 Font B/C: 64
	Character Set	English: 95 Expanded Graphics: 128 × 33 pages International: 32
	Barcode	1D: UPC A, UPC E, CODE 39, CODE 93, Code 128, EAN 8, EAN 13, ITF, CODABAR 2D: PDF417, DATAMATRIX, MAXI, QR Code, GS1 DataBar, Aztec
	Emulation	BXL/POS
Media	Sensor	Receipt media
	Cutter Type	Tear-bar
	Language	User language supported
	Media Shape	Receipt media
	Outer Diameter of Media Roll	Max. Ø50 mm (1.97 inch)
	Width	80 mm (3.16 inch)
	Thickness	0.07 ± 0.005 mm

Printer Cleaning

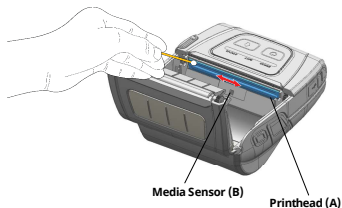

- 1) Turn off the printer and disconnect all cables from the product.
- 2) Open the media cover and remove any media inside.
- 3) Clean the printhead (A) using the cloth or cotton swab soaked in alcohol for medical.
- 4) Using the cloth or cotton swab soaked in alcohol for medical, remove the media dust from the black mark sensor (B).
(Sensor could be located in the middle or on left or on right)
- 5) Do not use the printer for one to two minutes after cleaning until the alcohol for medical has completely evaporated and dried.
- 6) Insert the media and close the media cover.
 - The head is very hot while the printer is running.

When cleaning the head, be careful not to touch the heating part of the head with your hands.

 - The head may be damaged by static electricity, etc.
 - Be careful not to scratch the head.
 - Be sure to turn off the power before you proceed with cleaning

WEEE



This marking shown on the product or its literature, indicates that it should not be disposed of with other household wastes at the end of its working life. To prevent possible harm to the environment or people from uncontrolled waste disposal, please separate this from other types of wastes and recycle it responsibly to promote the sustainable reuse of material resources. Household users should contact either the retailer where they purchased this product, or their local government office, for details of where and how they can take this item for environmentally safe recycling. Business users should contact their supplier and check the terms and conditions of the purchase contract. This product should not be mixed with other commercial wastes for disposal.

Battery Safety Precautions

1. If the battery is not charged after the charging time, stop charging and contact the seller.
2. Store and use the battery where it will not come into contact with liquid (water, salt water etc.). There may be a risk of overheating, rupturing or igniting.
3. Avoid exposing the battery to high temperatures over 50 °C and do not store or use it in a place with high temperature and humidity. There may be a risk of overheating, rupturing or igniting. In addition, it may reduce the performance and life of the battery. There is a risk of explosion, especially when the battery is placed by a fire or stored near a heating device (e.g., heater, etc.).
4. Utilize the USB-Type-C (A to C) cable provided by Bixolon to charge the battery.
5. If not, it may result in poor battery performance, shorten battery life or product failure.
6. Avoid causing any strong impact to the battery or throwing it. The protective device inside the battery may be damaged, which may reduce the battery performance and life, or there may be a risk of overheating, rupturing or igniting.
7. Do not disassemble or modify the battery. The battery contains safety and protection devices to prevent danger. It may reduce battery performance and life due to damage, or there may be a risk of overheating, rupturing or igniting.

Safety Precautions



WARNING & CAUTION

It describes death, physical injuries, serious financial losses, and damage to data etc. that can be caused to the user.

Do not connect multiple products to one single power outlet. Do not connect the product to a loose power outlet. Use only power outlets that meet the standard. Connect the power cord only to a grounded power outlet. **Noncompliance may cause electric shock or fire.**



Use only authentic products from BIXOLON. The company will not provide post-sale support for damage or other quality issues that any fake (refurbished) products may incur.



Do not bend or strain the power cord excessively. Push the power cord all the way into the power outlet let it remain loose. Make sure to hold the cord tight when separating it from the power outlet. Do not remove the power cord while the product is in use. **Noncompliance may cause electric shock or fire.**



Keep small accessories or other packaging materials away from young children. Beware: children may swallow them. Mishandling the product may incur injuries. If a child has swallowed any such thing, see a doctor at once.



Do not touch the power cord with wet hands when pulling it from a power outlet. If the power plug or outlet is smeared with extraneous matter, wipe it with a dry cloth. **Noncompliance may cause electric shock or fire.**



Do not allow the product to be damaged by heavy objects. **Noncompliance may cause electric shock or fire.**



If the product emits a strange sound, burning smell, or smoke, turn off the power immediately and unplug the power cord. If the product is dropped or its exterior is damaged, turn off the power immediately and unplug the power cord. Do not subject the product to shock. **It may start a fire. It may damage the product.**



Install the product in a well-ventilated place by keeping it a certain distance from the wall. The product installed in certain places such as where a lot of fine dust is generated, where the temperature is too high or too low, where there is a lot of moisture or water, and at airports or stations that are used continuously for a long time may suffer serious quality problems due to the influence of the surrounding environment. An increase in internal temperature may start a fire. Be sure to contact the place of purchase before installing the product.

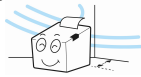

Install the product in a fixed place preventing it from tipping over. When moving the product, turn off the power and disconnect all cables connected to the product, including the power cord. **It may damage the product.**



Never disassemble, repair, or modify the product at your own discretion. **When repair is necessary, contact the place of purchase.**



Do not let any foreign substances enter the product. Do not place heavy objects, liquids, or metals on the product. **It may start a fire. It may damage the product.**



If there is a problem with the product, please contact the place of purchase. In addition, Bixolon website (<http://www.bixolon.com>) provides product repair.



◆ 안내

본 설치 안내서는 제품 설치에 필요한 간단한 정보만 기록하고 있습니다. 자세한 설치 안내는 웹사이트 사용 설명서를 참고하세요. 웹사이트에 포함되어있는 내용은 아래와 같습니다.

1. 매뉴얼: 사용자, 블루투스 연결, BXL/POS 명령어, 코드 페이지, 소프트웨어
2. 드라이버: Windows, OPOS, Linux & Mac CUPS
3. SDK: Android, Linux, Windows, iOS
4. 유틸리티: Bixolon Utility (Android, iOS), Unified Mobile Utility

저희 (주)빅솔론은 제품의 기능과 품질 향상을 위하여 지속적인 개선을 하고 있습니다.

이로 인하여 제품의 사양과 매뉴얼의 내용은 사전 통보 없이 변경될 수 있습니다.

(주)빅솔론의 본사 및 지사 주소와 전화번호는 빅솔론 홈페이지를 참고하시기 바랍니다.

(<http://www.bixolon.com>)

◆ 구성품 확인



프린터 설치 안내서

◆ 제품의 주요 명칭

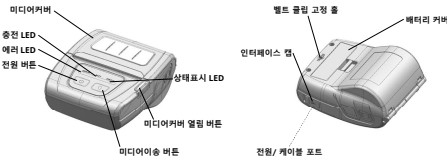

◆ 설치 및 충전

배터리 설치

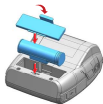

- 1) 그림과 같이 프린터에 배터리를 장착하세요.
- 2) 프린터 밑면에 배터리 커버의 훅(hook)을 결합하세요.
- 3) 딸깍하는 소리가 날 때까지 배터리 커버를 닫으세요.



배터리는 충전되지 않은 상태로 판매됩니다.

미디어 설치



- 1) 열림 버튼을 눌러 미디어커버를 열어주세요.
- 2) 그림과 같이 미디어를 넣으십시오. (다 사용한 미디어의 지관이 있다면 꺼내십시오.)
- 3) 미디어를 넣을 때에는 용지의 방향이 정확히지 확인하세요.
- 4) 그림과 같이 미디어를 앞으로 당긴 다음 미디어 커버를 닫으십시오
- 5) 여분의 미디어는 프린터 앞으로 잡아당겨 찢어내십시오.

배터리 충전



- 1) 프린터 전원을 꺼주세요.
- 2) ① 인터페이스 캡을 열어 주세요.
- 3) 프린터의 전원/케이블 포트에 USB Type-C 케이블 ②을 연결해주세요.
- 4) 단말기 (PDA, PC 등)의 USB 포트에 USB Type-C 케이블 ③을 연결 후 충전해주세요.



- 반드시 전원을 종료하고, 배터리를 충전하세요.
- 반드시 빅솔론에서 공급하는 정품만 사용하세요. 그렇지 않을 경우 제품의 고장 원인이 되거나 사용자의 부상 위험이 있습니다.

벨트 클립 설치

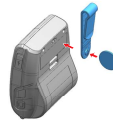

- 1) 벨트 클립 고정홈에 벨트 클립 스크류를 삽입하세요.
- 2) 그림과 같이 동전 등으로 벨트 클립 스크류를 체결하세요.

◆ 조작부 사용법



전원 버튼



미디어 이송 버튼



에러/충전/상태표시 LED

• 전원 버튼

이 버튼은 전원을 켜거나 끌 때 사용합니다.

• 미디어 이송 버튼

이 버튼은 미디어를 인위적으로 이송시키거나 셀프 테스트와 16 진수 DUMP를 출력할 때 사용됩니다.

• 에러 LED

적색 LED 가 깜빡이면 미디어커버가 열렸거나 미디어 없음 또는 헤드가 가열된 상태입니다. 적색 LED 가 계속 깜빡이면 제품에 이상이 발생한 경우일 수 있으므로 서비스센터로 문의해주세요.

• 충전 LED

녹색 LED 가 켜지면 완전 충전 상태입니다.

녹색 LED 가 깜빡이면 절반 충전 상태입니다.

적색 LED 가 깜빡이면, 배터리를 충전하거나 교환해야 합니다.

• 상태표시 LED

블루투스 사용시 청색 LED 가 배터리 잔량 표시등과 함께 켜지면 프린터는 블루투스 무선 통신이 가능한 상태입니다.

◆ 셀프 테스트

프린터를 처음 설정하거나 문제가 있을 경우 실행하여 프린터의 설정 정보를 확인할 수 있습니다. Self-Test 결과 프린터에 문제가 없을 경우 다른 장치나 소프트웨어를 살펴보세요. 이 기능은 다른 장치나 소프트웨어와 독립적으로 동작 합니다.

• 셀프 테스트 방법

- 1) 프린터 전원을 끄고 프린터 미디어 커버를 닫으십시오.
- 2) 미디어이송 버튼을 누르면서 동시에 전원 버튼을 누르면 전원이 켜집니다.
- 3) 인쇄가 시작되면 두 버튼을 놓으십시오.

◆ 외부 장치 연결



- 블루투스 연결
 - 프린터는 블루투스 통신이 가능한 단말기(PDA, PC 등)와 연결이 가능합니다.
 - 단말기에서 지원하는 블루투스 연결 기능을 사용하여 프린터와 연결합니다.

- 자세한 내용은 블루투스 연결매뉴얼을 참고하세요.
- 설정된 블루투스 환경(authentication, Encryption, connection mode)은 Self-Test를 통과하여 확인할 수 있습니다.



인터페이스 케이블은 USB2.0을 지원하는 USB Type-C 케이블을 사용하거나 빅솔론에서 공급(별도판매)하는 USB Type-C 케이블을 사용할 수 있습니다.

◆ 제품 사양서

	항목	설명
인쇄	인쇄 방식	감열 방식 인쇄
	인쇄 속도	최대 50 mm/s (1.97 ips)
	해상도	203 dpi
	문자 크기	폰트 A: 12 × 24 폰트 B: 9 × 17 폰트 C: 9 × 24
	리얼타임 데이터 수	폰트 A: 48 폰트 B/C: 64
	문자 집합	영문 숫자: 95, 확장 그래픽: 128 × 33 pages, 국제 문자: 32
	바코드	1 차원: UPC A, UPC E, CODE 93, CODE 93, Code 128, EAN 8, EAN 13, ITF, Codabar 2 차원: PDF417, DATAMATRIX, MAXI, QR Code, GS1 DataBar, Aztec
	에뮬레이션	BX/LPOS
	센서	용지 센서
	커터 유형	떼개형 커터(Tear-bar)
미디어	언어	고객 언어 지원
	미디어 종류	영수증 미디어
	미디어 외경	최대 Ø50 mm (1.97 inch)
	폭	80mm (3.16inch)
	두께	0.07 ± 0.005 mm

◆ 프린터 청소

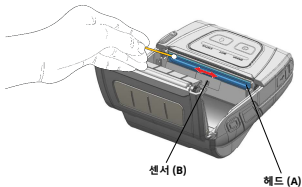

- 프린터의 전원을 종료하고 모든 케이블을 제품과 분리해주세요.
- 미디어 커버를 열고 용지가 있으면 제거해주세요.
- 의류용 알코올을 적신 천이나 면봉을 사용하여 프린터의 헤드(A) 부분을 닦아주세요.
- 의류용 알코올을 적신 천이나 면봉으로 미디어 센서(B)의 지분 (미디어 가루)을 제거해주세요. (센서는 중앙에 위치하고 있습니다.)
- 청소 후 의류용 알코올이 완전히 증발하여 건조될 때까지 1-2 분 동안 프린터를 사용하지 마세요.
- 프린터에 미디어를 넣고 미디어 커버를 닫아주세요.

- 프린터가 동작하는 동안 헤드부분은 매우 뜨거워질 수 있습니다.
- 헤드 청소 시 손으로 헤드의 가열부를 만지지 않도록 주의하세요.
- 헤드가 장기간 등에 의해 손상될 수 있습니다.
- 헤드에 흠집이 발생하지 않도록 주의하세요.
- 반드시 전원을 종료하고, 청소를 진행해주세요.

◆ 배터리 안전 주의사항

- 충전 시 소정의 충전시간이 지나도 충전이 되지 않을 경우 충전용 증전을 중지하고, 구매처에 문의하십시오.
- 배터리를 액체(물, 염 등)에 닿지 않는 곳에서 보관 및 사용하십시오. 배터리의 발열 · 팽창 · 발화 등의 위험이 있습니다.
- 배터리를 50°C이상의 고온 노출은 피하고, 고온 다습한 곳에서의 보관 및 사용하지 않아 주십시오. 발열 · 팽창 · 발화 등의 위험이 있습니다. 또, 배터리의 성능과 수명을 저하시킬 수 있습니다.
특히 배터리를 볼 속에 넣거나 발열장치(난방기 등) 주변에 보관할 경우 폭발의 위험이 있습니다.
- 배터리의 충전은 당사기 제공되는 USB Type-C (A to C) 정품 케이블을 사용해주세요.
그렇지 않을 경우 배터리 성능과 수명이 저하되거나 제품고장의 원인이 됩니다.
- 배터리에 강한 충격을 주거나 던지지 마십시오. 배터리에 들어있는 보호장치가 파괴되어 배터리 성능과 수명이 저하되거나 발열 · 팽창 · 발화 등의 위험이 있습니다.
- 배터리를 분해하거나 개조하지 마십시오. 배터리에선 위험을 방지 하기 위한 안전기구 및 보호장치가 들어 있습니다. 손상으로 인한 배터리의 성능과 수명이 저하되거나 발열 · 팽창 · 발화 등의 위험이 있습니다.

◆ 안전상의 경고



주의 & 경고

사용자의 사망 또는 신체적 손상, 심각한 재산상의 손상, 데이터 등의 정보 손상을 일으킬 가능성이 있는 내용을 설명합니다.

하나의 콘센트에 여러 제품을 동시에 연결하지 마세요. 일거ום 콘센트는 사용하지 마세요. 콘센트는 규격 제품의 사용하세요. 반드시 적지된 콘센트에 전원 코드를 연결하세요. **감전 및 화재의 위험이 있습니다.**

반드시 빅솔론에서 공급하는 정품만 사용하세요. **유사품(재생품) 사용으로 인한 제품손상에 대한 품질 및 A/S 책임을 지지 않습니다.**

전원 코드를 무리하게 구부리거나 잡아당기지 마세요. 전원 코드가 흔들리도록猛烈하게 흔들어 주지 마세요. 전원 코드를 콘센트에서 분리할 때에는 반드시 손으로 잡고 분리하세요. 제품 사용 중에는 자외선을 사용하지 마세요. **감전 및 화재의 위험이 있습니다.**

소용 액세서리 또는 포장품은 아이의 손이 닿지 않는 곳에 보관하세요. 아이가 삼키지 않도록 주의하세요. **제품을 어린이의 손이 닿지 않는 곳에 보관하세요. 어린이가 사용할 때에는 반드시大人的 감독하에 사용하세요.**

전원 코드를 꽂을 때 뽑을 때 찰음 손으로 만지지 마세요. 전원 코드의 한 부위 또는 콘센트의 이물질이 꽂아 있을 때에는 다른 천으로 깨끗이 닦아주세요. **감전 및 화재의 위험이 있습니다.**

무거운 물건에 놓이지 않도록 주의하세요. **감전 및 화재의 위험이 있습니다.**

제품에서 이물질이 나오는지, 냄새, 연기,가,뾰루시 증기를 끄고 전원 플러그를 뽑아주세요. 제품을 밀어쓰거나,가,의관이나핀으로 경우 즉시 전원 코드를 뽑아주세요. 제품을 충격하지 마세요. **화재의 위험이 있습니다. 제품 손상 위험이 있습니다.**

제품은 벽과 밀착기어볼 두이 통풍이 잘리는 곳에 설치하세요. 미세 먼지가 많이 발생하는 곳, 온기가 너무 높거나 낮은 곳, 습기가 많이 있는 곳, 장기간 연속적으로 사용하는 공형이나 역 등 특수한 장소에 설치된 제품은 주변 환경에 영영으로 심각한 환경 문제가 발생할 수 있습니다. **내부 온도 상승으로 인한 화재 위험이 발생할 수 있습니다. 반드시 구입처에 문의 주십시오.**

제품이 넘어지지 않도록 고정된 장소에 설치하세요. 제품을 흔들 때에는 전원 코드를 제품이 연결된 모든 선을 잡아주세요. 제품을 들어서 옮길 때에는 앞이드르지지 마세요. **제품 손상 위험이 있습니다.**

사용자 임의로 절대 분리, 수리, 개조하지 마세요. **수리가 필요할 때에는 구입처로 연락하세요.**

제품 내부에 이물질이 들어가지 않도록 주의하세요. 제품 위에 무거운 물건이나 액류,기류 금속류를 올려놓지 마세요. **화재의 위험이 있습니다. 제품 손상 위험이 있습니다.**

제품의 문제가 생겼을 경우 구입처로 연락하세요. 또한 빅솔론 홈페이지 (<http://www.bixolon.co.kr>) 에서 제품 수리 담당자를 제공받고 있습니다.



Information

This installation guide contains quick information required for the product installation. Refer to the User's Manual in the website that comes with the product for detailed installation instructions. The website contains the following information.

1. Manual: User's, Bluetooth Connection, BXL/POS Command, Code Pages, Software
2. Driver: Windows, OPOS, JPOS, CUPS(Linux, Mac)
3. SDK: UPOS SDK(android, iOS), Windows SDK
4. Utility: Bixelon Utility (Android, iOS), Unified Mobile Utility

We at BIXOLON Co., Ltd. maintain ongoing efforts to enhance and upgrade the functions and quality of all our products. In following, product specifications and/or user manual content may be changed without prior notice.

Please refer to the BIXOLON website for the addresses and phone numbers of the company's headquarters and branch offices. (<http://www.bixelon.com>)

Content Confirmation



Product Part Names

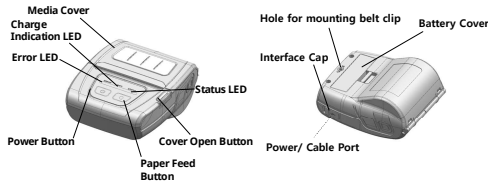

Installation and Charging

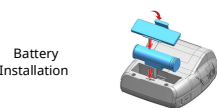

- 1) Insert battery into the printer as pictured.
- 2) Connect the hook of the battery cover to the bottom of the printer.
- 3) Press the battery cover into place until you hear a "click" sound.

Since the battery is partially charged at the time of purchase, charge the battery prior to product use.

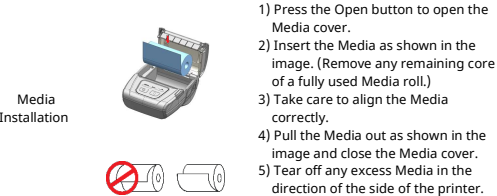

- 1) Press the Open button to open the Media cover.
- 2) Insert the Media as shown in the image. (Remove any remaining core of a fully used Media roll.)
- 3) Take care to align the Media correctly.
- 4) Pull the Media out as shown in the image and close the Media cover.
- 5) Tear off any excess Media in the direction of the side of the printer.

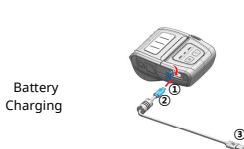

- 1) Turn off the printer power.
- 2) ① Open the external interface cap.
- 3) Connect USB Type-C cable ② to printer power/cable port.
- 4) Charge after connecting USB Type-C cable ③ to your device's (PDA, PC, etc.) USB port.



- Charge the battery only after disconnecting the power to your device.
- Use only genuine products supplied by Bixelon. Otherwise, the product may malfunction or there is a risk of personal injury.

Belt Clip
Installation



- 1) Insert the belt clip screw into the belt clip hole.
- 2) Use a coin to tighten the belt clip screw as shown in the image.

Control Panel Usage

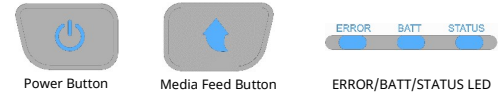

- **Power Button**
This button is used to turn the printer on and off.
- **Media Feed Button**
To feed media manually, press this button.
- **ERROR LED**
If the red LED is blinking, the media cover is open or missing, or the head is overheated. If the red LED continues to blink, it may indicate a more serious problem with the product.
Call your authorized service center.
- **BATT LED**
If the green LED is lit, the battery is fully charged.
If the green LED is blinked, the battery is half charged.
If the red LED is blinked, the battery must be charged or replaced.
- **STATUS LED**
When using Bluetooth, if the green LED and the battery indicator are both on, the printer is connected to Bluetooth.

Self-Test

Run the self-test to check the setting information when you are setting up the printer for the first time or if there is a problem.
If no issue is found with the printer after running the self-test, examine the other devices or peripherals and software. This function is independent of such other devices and software.

Self-Test Instructions

- 1) Turn the printer power off and close the printer media cover.
- 2) Press and hold the media feed button and power button simultaneously to turn on the printer.
- 3) After printing begins, release the two buttons.

Peripherals Connection

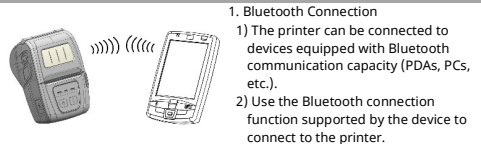

- Refer to the Bluetooth Connection Manual for detailed information on its connection.
- You can check the bluetooth environment (authentication, encryption, connection mode) via the self-test page.



A USB Type-C cable that supports USB 2.0 or a USB Type-C cable supplied (sold separately) by Bixelon can be used as an interface cable.

Product Specifications

Item	Description	
Printing Method	Direct Thermal printing	
Printing Speed	Up to 50 mm/s (1.97 ips)	
Resolution	203 dpi	
Character Size	Font A: 12 × 24 Font B: 9 × 17 Font C: 9 × 24	
Characters Per Line	Font A: 48 Font B/C: 64	
Printing	Character Set	English: 95 Expanded Graphics: 128 × 33 pages International: 32
	Barcode	1D: UPC A, UPC E, CODE 39, CODE 93, Code 128, EAN 8, EAN 13, ITF, Codabar 2D: PDF417, DATAMATRIX, MAXI, QR Code, GS1 DataBar, Aztec
	Emulation	BXL/POS
	Sensor	Receipt media
	Cutter Type	Tear-bar
	Language	User language supported
Media	Media Shape	Receipt media
	Outer Diameter of Media Roll	Max. Ø50 mm (1.97 inch)
	Width	80 mm (3.16 inch)
	Thickness	0.07 ± 0.005 mm

Printer Cleaning

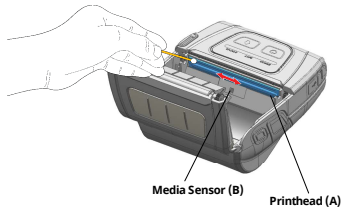

- 1) Turn off the printer and disconnect all cables from the product.
- 2) Open the media cover and remove any media inside.
- 3) Clean the printhead (A) using the cloth or cotton swab soaked in alcohol for medical.
- 4) Using the cloth or cotton swab soaked in alcohol for medical, remove the media dust from the black mark sensor (B).
(Sensor could be located in the middle or on left or on right)
- 5) Do not use the printer for one to two minutes after cleaning until the alcohol for medical has completely evaporated and dried.
- 6) Insert the media and close the media cover.
 - The head is very hot while the printer is running.

When cleaning the head, be careful not to touch the heating part of the head with your hands.

 - The head may be damaged by static electricity, etc.
 - Be careful not to scratch the head.
 - Be sure to turn off the power before you proceed with cleaning



WEEE

This marking shown on the product or its literature, indicates that it should not be disposed of with other household wastes at the end of its working life. To prevent possible harm to the environment or people from uncontrolled waste disposal, please separate this from other types of wastes and recycle it responsibly to promote the sustainable reuse of material resources. Household users should contact either the retailer where they purchased this product, or their local government office, for details of where and how they can take this item for environmentally safe recycling. Business users should contact their supplier and check the terms and conditions of the purchase contract. This product should not be mixed with other commercial wastes for disposal.



Battery Safety Precautions

1. If the battery is not charged after the charging time, stop charging and contact the seller.
2. Store and use the battery where it will not come into contact with liquid (water, salt water etc.). There may be a risk of overheating, rupturing or igniting.
3. Avoid exposing the battery to high temperatures over 50 °C and do not store or use it in a place with high temperature and humidity. There may be a risk of overheating, rupturing or igniting. In addition, it may reduce the performance and life of the battery. There is a risk of explosion, especially when the battery is placed by a fire or stored near a heating device (e.g., heater, etc.).
4. Utilize the USB-Type-C (A to C) cable provided by Bixolon to charge the battery.
5. If not, it may result in poor battery performance, shorten battery life or product failure.
5. Avoid causing any strong impact to the battery or throwing it. The protective device inside the battery may be damaged, which may reduce the battery performance and life, or there may be a risk of overheating, rupturing or igniting.
6. Do not disassemble or modify the battery. The battery contains safety and protection devices to prevent danger. It may reduce battery performance and life due to damage, or there may be a risk of overheating, rupturing or igniting.

Safety Precautions



WARNING & CAUTION

It describes death, physical injuries, serious financial losses, and damage to data etc. that can be caused to the user.

Do not connect multiple products to one single power outlet. Do not connect the product to a loose power outlet. Use only power outlets that meet the standard. Connect the power cord only to a grounded power outlet. **Noncompliance may cause electric shock or fire.**



Use only authentic products from BIXOLON. The company will not provide post-sale support for damage or other quality issues that any fake (refurbished) products may incur.

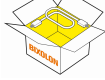

Do not bend or strain the power cord excessively. Push the power cord all the way into the power outlet lest it remain loose. Make sure to hold the cord tight when separating it from the power outlet. Do not remove the power cord while the product is in use. **Noncompliance may cause electric shock or fire.**



Keep small accessories or other packaging materials away from young children. Beware: children may swallow them. Mishandling the product may incur injuries. If a child has swallowed any such thing, see a doctor at once.



Do not touch the power cord with wet hands when pulling it from a power outlet. If the power plug or outlet is smeared with extraneous matter, wipe it with a dry cloth. **Noncompliance may cause electric shock or fire.**



Do not allow the product to be damaged by heavy objects. **Noncompliance may cause electric shock or fire.**



If the product emits a strange sound, burning smell, or smoke, turn off the power immediately and unplug the power cord. If the product is dropped or its exterior is damaged, turn off the power immediately and unplug the power cord. Do not subject the product to shock. **It may start a fire. It may damage the product.**



Install the product in a well-ventilated place by keeping it a certain distance from the wall. The product installed in certain places such as where a lot of fine dust is generated, where the temperature is too high or too low, where there is a lot of moisture or water, and at airports or stations that are used continuously for a long time may suffer serious quality problems due to the influence of the surrounding environment. An increase in internal temperature may start a fire. Be sure to contact the place of purchase before installing the product.

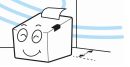

Install the product in a fixed place preventing it from tipping over. When moving the product, turn off the power and disconnect all cables connected to the product, including the power cord. **It may damage the product.**



Never disassemble, repair, or modify the product at your own discretion. **When repair is necessary, contact the place of purchase.**



Do not let any foreign substances enter the product. Do not place heavy objects, liquids, or metals on the product. **It may start a fire. It may damage the product.**



If there is a problem with the product, please contact the place of purchase. In addition, Bixolon website (<http://www.bixolon.com>) provides product repair.



دليل تثبيت الطابعة

الطابعة المحمولة SPP-C300

المعلومات

يحتوي دليل التثبيت هذا على المعلومات السريعة المطلوبة لتثبيت المنتج. ارجع إلى دليل مستخدم المنتج المتاح على الموقع الإلكتروني للحصول على تعليمات التثبيت التفصيلية. يحتوي الموقع الإلكتروني على المعلومات التالية:

1. الدليل: المستخدم، التوصيل عبر بلوتوث، الأمر BXL/POS، صفحات الكود، البرمجيات
2. نظام التشغيل: Windows, OPOS, JPOS, CUPS(Linux, Mac)
3. SDK: UPOS SDK(android, iOS), Windows SDK
4. الأدوات المساعدة: أداة Bixolon المساعدة (Android, iOS)، الأداة المساعدة للوحدات المحمولة

نحن شركة BIXOLON المحدودة حريصون باستمرار على بيل كافة الجهود لتحسين وترقية وظائف وجودة جميع منتجاتنا. وبناءا عليه، يمكن أن تتغير مواصفات المنتج و/ أو محتويات دليل المستخدم بدون إشعار مسبق. يرجى الرجوع إلى موقع BIXOLON على الإنترنت للتعرف على العناوين وأرقام الهاتف الخاصة بمقر الشركة ومكاتب الفروع. (<http://www.bixolon.com>)

تأكيد المحتويات



مشبك الحزام

USB من النوع C (من A إلى C) كابل الواجهة

مجموعة البطارية

SPP-C300



دليل تثبيت الطابعة

أسماء أجزاء المنتج

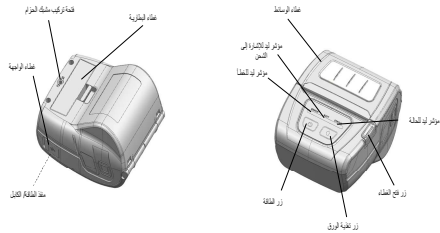

فتحة تركيب شبكة الجراد

غطاء البطارية

غطاء الإسقاط

مؤشر قيد التشغيل

مؤشر قيد الخطأ

زر إيقاف

زر إعادة

زر تشغيل

زر إيقاف

زر إيقاف

زر إيقاف

زر إيقاف

زر إيقاف

التثبيت والشحن

1. ادخل البطارية في الطابعة كما هو موضح في الصورة.
2. صل حطاف غطاء البطارية بالجانب السفلي من الطابعة.
3. اضغط غطاء البطارية في المكان المخصص له حتى تسمع صوت "قرقرة".

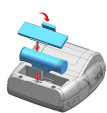

تثبيت البطارية

بما أن البطارية تزود مشحونة جزئيا في وقت الشراء، قم بشحن البطارية قبل البدء في استعمال المنتج.

1. اضغط زر الفتح لفتح غطاء الوسائط.
2. ادخل الوسائط كما هو موضح في الصورة. (أول أي أجزاء متبقية من لبقة الوسائط المستخدمة بالكامل).
3. انتبه لمحاذاة الوسائط بشكل صحيح.
4. اسحب الوسائط إلى الخارج كما هو موضح في الصورة.
5. قم بإزالة أي وسائط زائدة عن طريق التمزيق في اتجاه جانب الطابعة.



الوسائط التثبيت



1. قم بإيقاف تشغيل الطابعة.
2. افتح غطاء الواجهة الخارجية.
3. قم بتوصيل كابل USB من النوع C ② بمنفذ الطاقة/الكابل في الطابعة.
4. قم بالمشحن بعد توصيل كابل USB من النوع C ③ بمنفذ USB للأجهزة الخاصة بك (PDA, PC) وما إلى ذلك.



شحن البطارية

- لا تقم بشحن البطارية إلا بعد فصل الطاقة عن الجهاز الخاص بك.
- لا تستخدم سوى المنتجات الأصلية المزودة من Bixolon ولا يمكن أن يتحمل المنتج أن تكون هناك مخاطر للإصابة الجسدية.



1. ادخل برغي مشبك الحزام في الفتحة الخاصة به.
2. استخدم قطعة صلبة معدنية في ريد برغي مشبك الحزام بإحكام كما هو موضح في الصورة.



مشبك الحزام التثبيت

استخدام لوحة التحكم



مؤشر قيد الخطأ/البطارية/الحالة



زر تغذية الوسائط



زر الطاقة

- زر الطاقة يستخدم هذا الزر في تشغيل وإيقاف تشغيل الطابعة.
- زر تغذية الوسائط اضغط هذا الزر لتغذية الوسائط يدوياً.
- مؤشر قيد الخطأ إذا كان مؤشر قيد الأحمر وامضاً، يعني ذلك أن غطاء الوسائط مفتوحاً أو ناقصاً، أو أن الرأس ساخناً بشكل زائد. إذا استمر مؤشر قيد الأحمر في الوميض، فقد يشير ذلك إلى مشكلة أكثر خطورة في المنتج.
- اتصل بمركز الخدمة المعتمد الخاص بك.
- مؤشر قيد للبطارية إذا كان مؤشر قيد الأخضر مضاء، يعني ذلك أن البطارية مكتملة الشحن.
- إذا كان مؤشر قيد الأخضر وامضاً، يعني ذلك أن البطارية مشحونة لنصف سعتها.
- إذا كان مؤشر قيد أحمر وامضاً، يعني ذلك ضرورة شحن البطارية أو استبدالها.
- مؤشر قيد للتحقق عند استخدام وظيفة بلوتوث، ففي حالة إضاءة مؤشر قيد الأخضر ومؤشر البطارية في نفس الوقت، يعني ذلك أن البطارية متصلة عبر بلوتوث.

الاختبار الذاتي

- شغل الاختبار الذاتي للتحقق من سلامة الإعداد عندما تقوم بإعداد الطابعة لأول مرة أو في حال حدوث مشكلة إذا لم يثر على مشاكل في الطابعة بعد تشغيل الاختبار الذاتي، الفحص الأجهزة الأخرى والأجهزة الطرفية والبرمجيات.
- هذه الوظيفة على تلك الأجهزة والبرمجيات الأخرى.
- تعليمات الاختبار الذاتي:
 1. اوقف تشغيل الطابعة وأغلق غطاء وسائط الطابعة.
 2. اضغط مع الاستمرار زر تغذية الوسائط وزر الطاقة في نفس الوقت لتشغيل الطابعة.
 3. حرر كلا الزرين بعد أن تبدأ الحطاعة.

توصيل الأجهزة الطرفية

1. التوصيل عبر بلوتوث
1. الطابعة قابلة للتوصيل بالأجهزة التي تشتمل على إمكانيات التوصيل عبر بلوتوث (PDAs وPCs وما إلى ذلك).
2. استخدم وظيفة التوصيل عبر بلوتوث التي يدعمها الجهاز للتوصيل بالطابعة.



ارجع إلى دليل التوصيل عبر بلوتوث للحصول على معلومات تفصيلية عن طريقة التوصيل هذه. ويمكن التحقق من بنية بلوتوث (المصادقة والتشفير ونمط الاتصال) من صفحة الاختبار الذاتي.



2. توصيل كابل الواجهة
1. افتح غطاء الواجهة الخارجية.
2. قم بتوصيل كابل USB من النوع C ② بمنفذ الطاقة/الكابل في الطابعة.
3. قم بتوصيل كابل USB من النوع C ③ بمنفذ USB للأجهزة الخاصة بك (PDA, PC) وما إلى ذلك.



يمكن استخدام كابل USB من النوع C يدعم USB 2.0 أو كابل USB من النوع C المزود من Bixolon (يتاح على حدة) ككابل واجهة.



احتياطات السلامة



التحذير والتثبيت

يُصنف وفاء وإسبابات جديدة وخمسة مليارية خضراء وأضواء تلحق بالبيانات وما إلى ذلك ويمكن أن تلحق بالمستخدم.

لا تلم بترسيل الحديد من المنتجات بغض النظر أبداً. لا تلم بتوسيل المنتج بغض النظر أبداً. غير مرطوب أبداً. لا تستخدم سري معادن الكهربية. لا تستخدمي المنظفات لتوسيل السلك الكهربائي سري بملف كهربية. موزعي. يمكن أن يتسبب عدم التوافق في الصدمة الكهربائية أو الحريق.



لا تستخدم سوي المنتجات الأصلية من BIXOLON. إن تقدم الشركة دعم ما بعد البيع في حالة تلف أو الممثل الأخرى المتعلقة بالجوهر التي يمكن أن تحدث نتيجة لاستخدام منتجاتنا (مجددة).



يجب تشغيل المنتج في بيئة جافة ودرجة الحرارة بين 5°C و 35°C. تجنب التعرض للرطوبة العالية. تجنب التعرض للحرارة العالية. تجنب التعرض للرياح القوية. تجنب التعرض للضوء المباشر.



لا تقم بلمس أو لمس السلك الكهربائي أكثر من الحد المسموح. لا تقم بتوسيل المنتج بغض النظر أبداً. غير مرطوب أبداً. لا تستخدم سري معادن الكهربية. لا تستخدمي المنظفات لتوسيل السلك الكهربائي سري بملف كهربية. موزعي. يمكن أن يتسبب عدم التوافق في الصدمة الكهربائية أو الحريق.



لا تعرض المنتج للأشياء الحادة التي لا يحدث تلف. يمكن أن يتسبب عدم التوافق في الصدمة الكهربائية أو الحريق.



لا لمس السلك الكهربائي وذلك بمكان قد يتسبب من ملامس الكهربية في حالة التلوث. تجنب التعرض للرطوبة العالية. تجنب التعرض للحرارة العالية. تجنب التعرض للرياح القوية. تجنب التعرض للضوء المباشر.

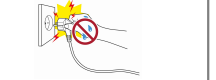

لا تلمس المنتج بغير سري. تجنب التعرض للرطوبة العالية. تجنب التعرض للحرارة العالية. تجنب التعرض للرياح القوية. تجنب التعرض للضوء المباشر.



لا تلمس المنتج بغير سري. تجنب التعرض للرطوبة العالية. تجنب التعرض للحرارة العالية. تجنب التعرض للرياح القوية. تجنب التعرض للضوء المباشر.



لا تلمس أبداً بتركيبك أو إصلاح أو تعديل المنتج بأصابعك. متى كان الإصلاح ضرورياً، اتصل بمكان الشراء.



لا تلمس المنتج في مكان يحدث له تكون أو تكون عرجلة الأنتلاك. عند تحريك المنتج، وفر تشغيل الطاقة لضمان كل الكابلات الموصولة به بما في ذلك السلك الكهربائي. في جميع تلك في تلف المنتج.



في حالة وجود أي مشكل في المنتج، يرجى الاتصال بمكان الشراء. كما يمكنك زيارة موقع Bixolon على الإنترنت <http://www.bixolon.com> يوفر خدمة إصلاح المنتجات.



لا تسمح لأي مواد عرجلة يدخلون المنتج. لا تسمح أي الأشياء الثقيلة أو سوائل أو معادن على المنتج. في جميع تلك في التلف المنتج.



مواصفات المنتج	
الوصف	البيانات
طريقة الطباعة	البيانات
سرعة الطباعة	حتى 80 ميث (1.97 ips)
الأسبقة	203 dpi (نقطة في البوصة)
حجم الحرف	الخط A: 24 × 9 B: الخط 24 × 17 C: الخط 24 × 9
الخط	الخط A: الخط 48 B/C: الخط 64
أنواع الحروف	الخط 95 (الخطية)
مجموعة الحروف	الرسومات المدمجة: 128 × 33 صفحة
توليف	32
البروتوكول	أحادي الأبعاد: UPC A, UPC E, CODE 39, CODE 93, CODE 128, EAN 8, EAN 13, ITF, Codabar ثنائي الأبعاد: PDF417, DATAMATRIX, MAXI, QR Code, GS1 DataBar, Aztec
المسككة	BXL/POS
المستشعر	استشعار الواسط
نوع القلم	قلم حبر
اللغة	لغة المستخدم مدمجة
شكل الواسط	استشعار الواسط
القطر الخارجي للفة	Ø50 مم (بوصة 1.97)
القطر الداخلي للفة	Ø40 مم (بوصة 1.57)
العرض	80 مم (بوصة 3.16)
السمك	0.07 - 0.005 مم

تنظيف الطباعة

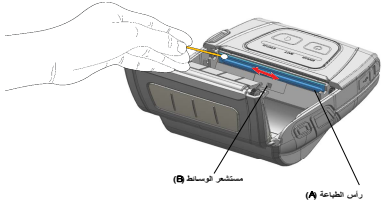

رأس الطباعة (A) مستشعر الواسط (B)

1. توقف تشغيل الطباعة وأزل كل الكابلات من المنتج.
2. افتح غطاء الواسط وأزل أي وسائط داخلها.
3. نظف رأس الطباعة (A) باستخدام قطعة قماش أو مسحة قطنية مبلوطة في الكحول للأغراض الطبية.
4. استخدم قطعة القماش أو المسحة القطنية المبلوطة في الكحول للأغراض الطبية في تنظيف الواسط من الأتربة بدايةً (B).
5. يمكن أن يكون المستشعر في المنتصف أو على اليسار أو اليمين.
6. لا تستعمل الطباعة لمدة دقيقة أو دقيقتين من بعد التنظيف حتى يتبخّر الكحول الطبي ويجف تماماً.

- يمكن أن يتسبب عدم التوافق في التلف المنتج.
- يمكن أن يتسبب عدم التوافق في التلف المنتج.
- يمكن أن يتسبب عدم التوافق في التلف المنتج.
- يمكن أن يتسبب عدم التوافق في التلف المنتج.



نفايات الأجهزة الكهربائية والإلكترونية (WEEE)

تتخذ هذه العلامة الموضحة على المنتج أو في الأوراق المصاحبة به إلى أنه لا يجب التخلص منه مع النفايات المنزلية الأخرى في نهاية عمر التشغيل. تجنب الضرر المحتمل للبيئة أو الأشخاص نتيجة التخلص من النفايات بطريقة غير سليمة. يرجى فصلها عن أنواع النفايات الأخرى وإعادة التدوير بشكل مسؤل لتقليل الأثر البيئي. استشر المصنّع أو المورد للحصول على مزيد من المعلومات. يمكن التخلص من النفايات الإلكترونية في حاويات خاصة مخصصة لهذا الغرض. يمكن التخلص من النفايات الإلكترونية في حاويات خاصة مخصصة لهذا الغرض. يمكن التخلص من النفايات الإلكترونية في حاويات خاصة مخصصة لهذا الغرض.



احتياطات السلامة للبطارية

1. إذا لم يزد شحن البطارية بعد توصيل الشاحن لمدة مناسبة، توقف عن الشحن واتصل بالبيع.
2. يجب تخزين وإسعمال البطارية بحيث لا تصل إليها أي سوائل (المياه والمخار وماء إلى ذلك). يمكن أن تؤدي هذه الأشياء إلى مخاطر السخونة الزائدة أو الانفجار.
3. تجنب تعريض البطارية لدرجات حرارة مرتفعة أعلى من 40 درجة مئوية، ولا تخزنها أو تستعملها في مكان ترتفع فيه درجة الحرارة ودرجة الرطوبة. يمكن أن تؤدي هذه الأشياء إلى مخاطر السخونة الزائدة أو الانفجار أو التلوث. بالإضافة إلى ذلك، فقد يتسبب بفتح بطارية مشحونة أو أداء ونقل عبر البطارية. ذلك، مستشعر ارتفاع الحرارة عند وضع البطارية بالقرب من النار أو تحريضها بالقرب من جهاز تسخين (مثل السخان وما إلى ذلك).
4. استخدم كابل USB من نوع (A إلى C) من Bixolon لتجنب الشحن البطارية في حالة عدم الإقتران. تجنب تلف بطارية أو تعريضها لخطر الانفجار أو التسبب في تلف المنتج.
5. لا تعرض البطارية لأي صدمات قوية ولا تلمس بالقطار. يمكن أن يتعرض الحامية بالبطارية للتلف، مما يمكن أن يتسبب في تلف مستوى أداء و عمر البطارية، أو قد يؤدي إلى مخاطر السخونة الزائدة أو الانفجار أو التلوث.
6. لا تلمس بقا أو تلتصق البطارية بتجويف البطارية على آلات الأمان والحماية تمنع في الخطر. يمكن أن يؤدي إلى تلف مستوى أداء و عمر البطارية، أو قد يتسبب في تلف مستوى أداء و عمر البطارية.