



**EU Battery Declaration**

This symbol on the battery or on the packaging indicates that the battery provided with this product should not be treated as household waste. Instead, please separate the battery/batteries from other types of waste and recycle them through your local recycling system to protect the environment and health. The chemical symbol for lead (Pb) is added under this symbol if the battery contains more than 0.004% lead. Additionally, the chemical symbol for cadmium (Cd) is added under this symbol if the battery contains more than 0.002% cadmium. For more detailed information about the recycling of these batteries, please contact your local authority or the shop where you purchased the product or batteries.



## Quick Installation Guide

### IDS 5554L/6554L Display

Revision B  
P/N EB10930

Learn more about Elo at [EloTouch.com](https://www.elotouch.com)

**America**

Tel +1 408 597 8000  
EloSales.NA@elotouch.com

**Europe (EMEA)**

Tel +32 16 930 136  
EMEA.sales@elotouch.com

**Asia Pacific**

Tel +86 (21) 3329 1385  
EloAsia@elotouch.com

The information in this document is subject to change without notice. Elo Touch Solutions, Inc. and its Affiliates (collectively "Elo") makes no representations or warranties with respect to the contents herein, and specifically disclaims any implied warranties of merchantability or fitness for a particular purpose. Elo reserves the right to revise this publication and to make changes from time to time in the content hereof without obligation of Elo to notify any person of such revisions or changes.

No part of this publication may be reproduced, transmitted, transcribed, stored in a retrieval system, or translated into any language or computer language, in any form or by any means, including, but not limited to, electronic, magnetic, optical, chemical, manual, or otherwise without prior written permission of Elo Touch Solutions, Inc.

Elo and the Elo logo are either trademarks or registered trademarks of Elo Touch Solutions, Inc.



Go to [www.elotouch.com/support](http://www.elotouch.com/support) to download user manual.  
 请访问 [www.elotouch.com.cn](http://www.elotouch.com.cn) 获取用户手册

### 1. Mounting ET5554L and ET6554L IDS Display (VESA Mount)

(Compatible Elo low-profile wall mount kit P/N E727774 available at [www.elotouch.com](http://www.elotouch.com))

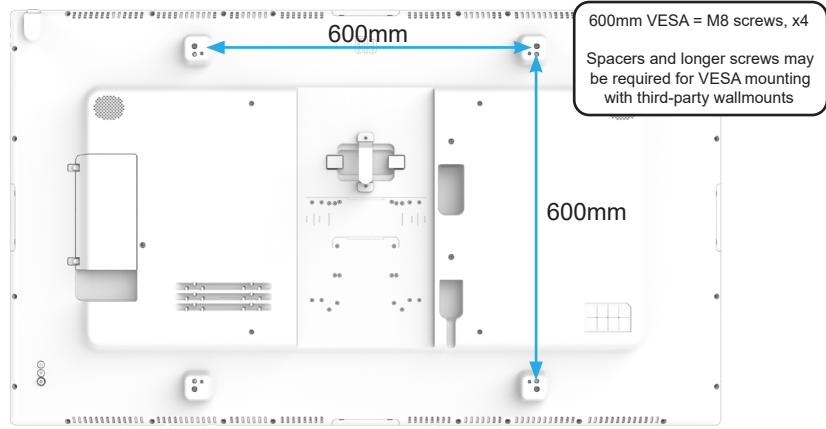

### 2. Connections

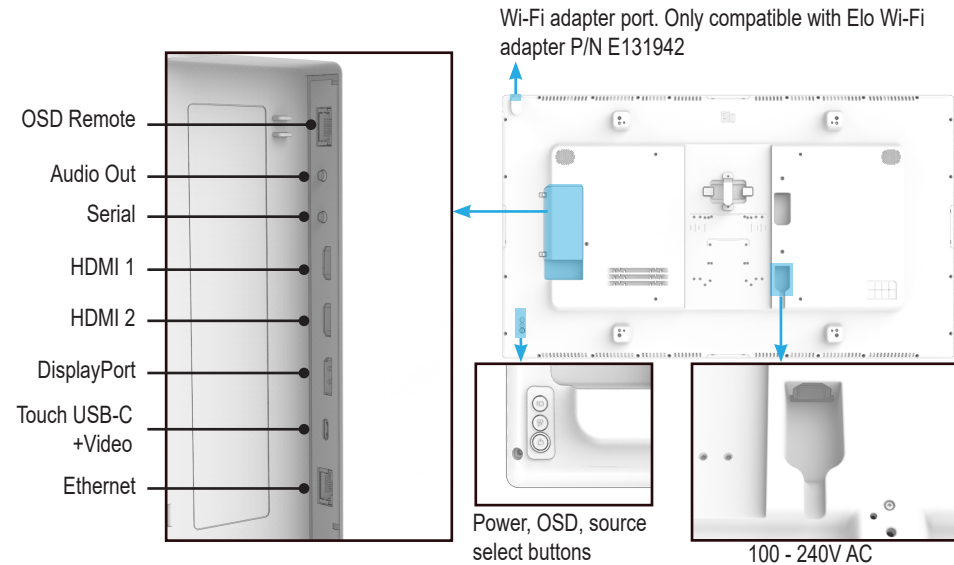

### 3. External Computer Mounting (computer sold separately)

100mm VESA pattern is available for the Elo Backpack™, Intel NUC, and other small computers with the same hole pattern.

Additionally, there are multiple patterns designed for select Brightsign players. Align the top of the Brightsign player with the horizontal marking and then center the player between the vertical markings to align the mounting holes on the player. Use M4x6 screws (included) to secure Brightsign players. See IDSx4 User Manual for detailed Brightsign Player compatibility list.



### 4. External computer power supply connection

Secure computer power supply with straps as shown below and connect power supply to IDS power output connection with the included cable. (Brightsign players require adapter which is not included). Connector DC cable from power supply to computer. Additional DC cable length can be wound up and secured under power supply before securing straps if desired.

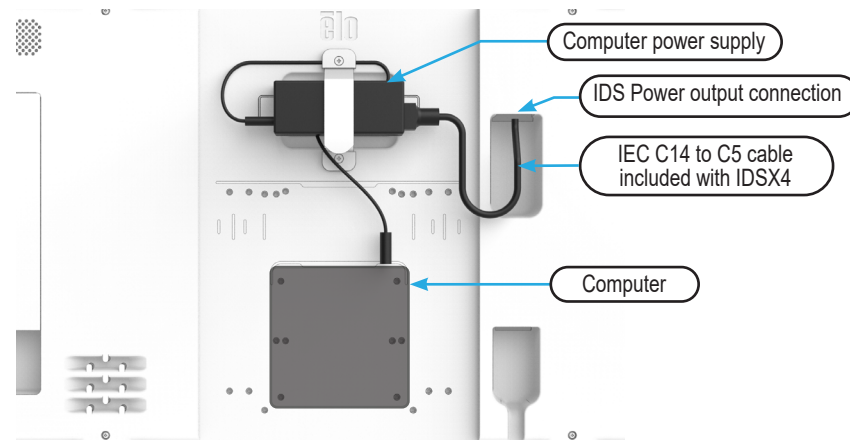

### 5. Elo Edge Connect Peripheral Mounting

Most popular accessories: 4K camera, Wall Mount, Magnetic Strip, 2D Barcode Reader. Scan QR code or visit:

<https://www.elotouch.com/accessories.html>

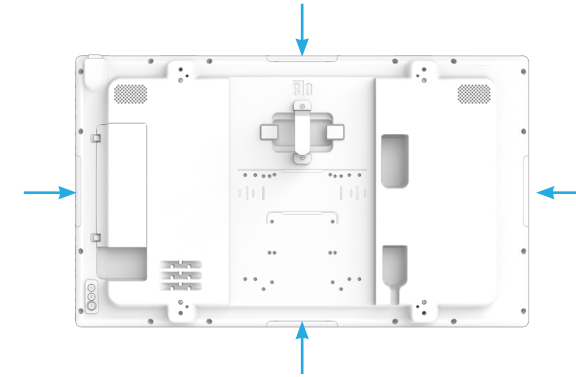

### 6. (Optional) EloView and IoT Setup (Elo document QIG590425)

Scan QR code or visit: <https://docs.elotouch.com/QIG590425.pdf>



### 7. (Optional) Connect IDS to ethernet router

(ethernet cable not included)

Warning! Do not connect router to remote OSD port.

